

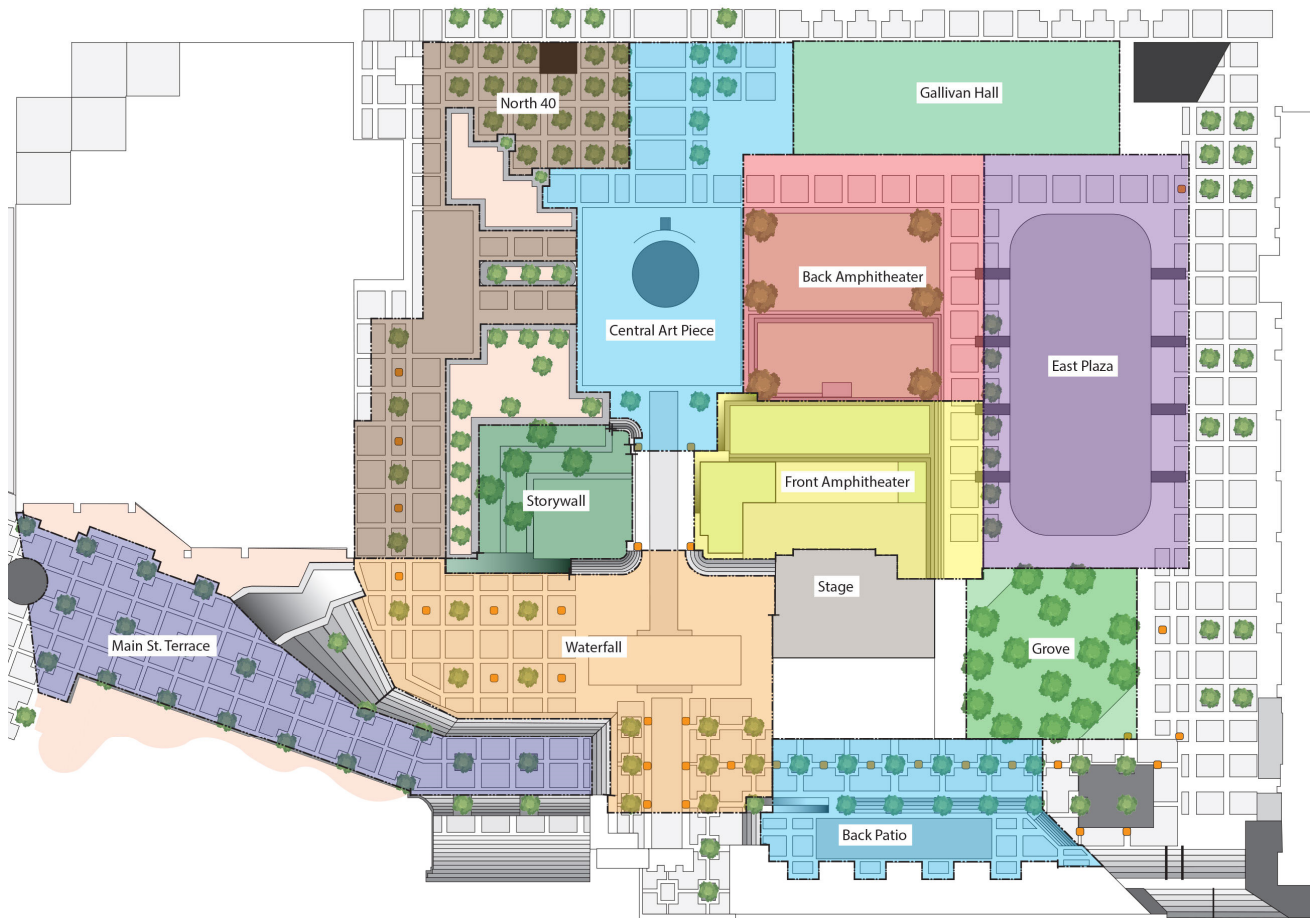

Rental Price List

Space rental and equipment rates are per day and staffing is charged hourly. Multiple day events will be considered multiple events, and each day will be charged separately.



Indoor Areas	Base Price
Gallivan Hall	\$2,200
Bridal Room	\$500
Stage	\$1,200
Outdoor Areas (Available May - Sept)	
Front Amphitheater	\$1,250
Back Amphitheater	\$1,500
Center Art Piece	\$1,250
North 40	\$1,000
East Plaza	\$1,500
Waterfall	\$1,000
Main Street Terrace	\$1,250
Story Wall	\$1,000
Grove	\$1,000
Patio	\$1,200
Restrooms	
Event Restrooms	\$1,750
Stage (Restrooms Only)	\$500

Discounted and Premium Rates	
Non-Profit	10% Discount
This discount is available to clients who provide their valid 501(c)(3) number	
Holiday	30% Premium
Our holiday rate applies to holidays recognized by Salt Lake City	
December	20% Premium
For any event occurring between Thanksgiving and New Year's Day	
Premium	30% Premium
Any event booked (by paying deposit) less than 30 days before the event date	

Equipment

Outdoor Equipment	Cost per item	Gallivan Hall Equipment	Cost per item
Canopy	\$150	3'x6' Tables	\$10
Canopy Walls	\$5	18"x96" Tables	\$10
Sandbags	\$5	60" Round Table	\$11
8' Low Vinyl Fencing	\$20	Chairs	\$3
3'x6' Tables	\$10	Cabaret Tables (30" or 42")	\$9
60" Round Table	\$11	Lectern	\$30
Cabaret Table - 30" Tall	\$9	Wireless Microphone	\$0
Cabaret Table - 42" Tall	\$9	Screen	\$60
Chairs	\$3	Projector	\$150
4'x8' Plywood	\$30	Portable Bar	\$60
Portable Bar	\$60		
 Stage Equipment		 Specialized Stage Equipment *	
3'x6' Tables	\$10	Can Lights	\$180
60" Rounds	\$11	LED Lights & Lightboard	\$300
Chairs	\$3	Fly Motors	\$120
Lectern	\$30	Giant Screen	\$300
Portable Screen & Projector	\$150	* will require AV vendor	
Portable PA System	\$180		
Portable Bar	\$60		
Bluetooth Speaker with Microphone	\$0		

Staffing

Type	Rate	Description
Supervisor	\$40 per hour	A supervisor is required for the entire duration of your access to the venue to answer venue related questions and ensure adherence to our policies and procedures.
Additional Event Staffing	\$52 per hour	For large events, we will determine your staffing needs on a case-by-case basis depending on the type of event, the areas being rented, and the number of attendees.