

## The Gallivan Center Rental Rates

Area	Rental	Non Profit	Holiday	Non-Profit	SqFt	Capacity	Location
Gallivan Hall	\$1,800.00	\$1,620.00	\$2,160.00	\$1,944.00	3,197	200/295	Inside
Stage	\$600.00	\$540.00	\$720.00	\$648.00	1,300	80/100	Inside
Stage (Restrooms Only)	\$300.00					500	Inside
Front Amphitheater	\$1,000.00	\$900.00	\$1,200.00	\$1,080.00	4,242	500	Outside
Back Amphitheater	\$1,000.00	\$900.00	\$1,200.00	\$1,080.00	4,597	300	Outside
Center Art Piece	\$1,100.00	\$990.00	\$1,320.00	\$1,188.00	7,990	600	Outside
East Plaza	\$1,100.00	\$990.00	\$1,320.00	\$1,188.00	8,328	800	Outside
Waterfall	\$800.00	\$720.00	\$960.00	\$864.00	9,702	800	Outside
Terrace	\$1,100.00	\$990.00	\$1,320.00	\$1,188.00	12,652	1,000	Outside
Story Wall	\$700.00	\$630.00	\$840.00	\$756.00	3,808	300	Outside
Grove	\$800.00	\$720.00	\$960.00	\$864.00	4,936	250	Outside
Patio	\$700.00	\$630.00	\$840.00	\$756.00	8,830	100	Outside
Outside Restrooms	\$1,500.00	\$1,350.00	\$1,800.00	\$1,620.00		6,000	Outside
<b>Total Plaza Rental</b>	<b>\$12,200.00</b>	<b>\$10,980.00</b>	<b>\$14,640.00</b>	<b>\$13,176.00</b>			

Outside areas are available May-September

Holiday rates are from Thanksgiving through New Years, observed holidays, and any high priority dates e.g. the olympics

Restrooms are located in Gallivan Hall, the Stage, and the Event Restrooms

Non-Profit rates are reserved for 501 C3 organizations only and require their designation number

Rates are for the space only, equipment is a separate charge (see below)

Event Area Map

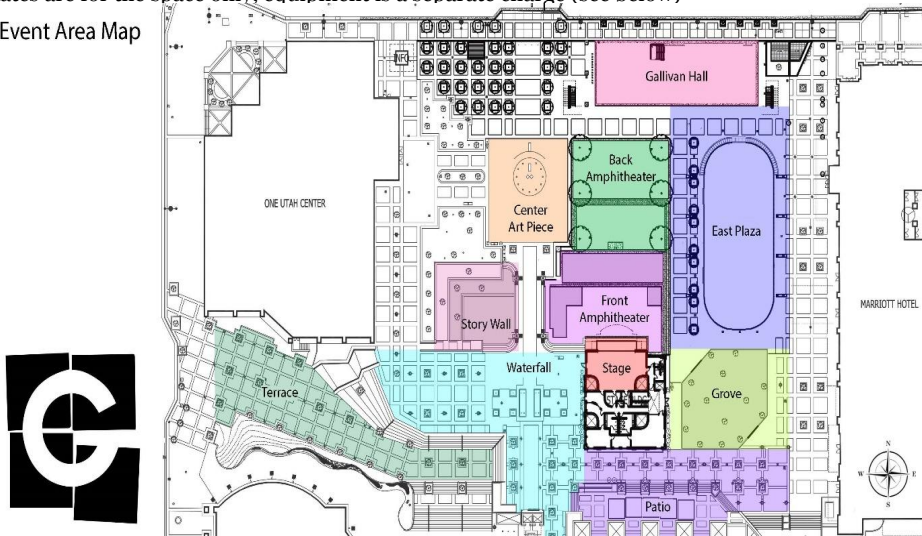

Staffing needs are based upon hours of access, locations used, and equipment rented

Supervisor Rate	\$35/hr	Adjusted for total access hours + 4 hrs for cleaning & resetting
Maintenance Fee	\$42/hr	Adjusted for food, alcohol, and areas utilized
Setup/Strike	\$35/hr	Added on for any equipment rented through the venue

Please indicate the desired amount of any known equipment needs for your event (can be identified later)

Gallivan Hall Equipment		Stage Equipment		Plaza Equipment	
3'x6' Table (\$10)		Can Lights (\$180)		Canopy (\$150)	
18"x96" Table (\$10)		LED Lights (\$300)		Sandbags (\$5)	
60" Rounds (\$11)		Fly Motors (\$120)		Walls (\$5)	
Chairs (\$3)		Portable PA (\$180)		8'x 4 Fencing (\$20)	
Cabaret Table (\$9)		Giant Screen (\$300)		3'x6' Tables (\$10)	
Lecturn (\$30)		Lecturn (\$30)		60" Rounds (\$11)	
Microphone		3'x6' Table (\$10)		Chairs (\$3)	
Screen (\$60)		60" Rounds (\$11)		Cabarets (\$9)	
Projector (\$150)		Chairs (\$3)		4'x8' Plywood (\$30)	
Portable Bar (\$60)		Portable Bar (\$60)		Portable Bar (\$60)	

60" Rounds can fit up to 8 people around them